



FOR LEASE

615 N. Poplar St.
Anaheim, CA

2,232 SF Industrial Unit

SITE HIGHLIGHTS:

- Business Park Environment
- Professional Property Management
- Premier Orange County Location
- Excellent Access to 57, 5 & 22 Freeways
- Drive Around Building
- M-1 Zone
- Parking Ratio 2:1,000

UNIT FEATURES:

- Two Private Offices
- LED Lighting
- High Ceilings
- Two Restrooms
- 17' Warehouse Clearance
- 10'x12' Grade Level Warehouse Door



FOR FURTHER DETAILS:

ERIN GARNER

erin@tricoREALTY.com
License #02228139

DAVID KLING

david@tricoREALTY.com
License #01965659

This information has been furnished from sources which we deem reliable; however, we do not guarantee its accuracy and assume no liability. Do not rely on any of the information contained herein without verifying it yourself directly with the listing broker or owner.

Trico Realty, Inc.
License #00342120

3100-A Pullman Street
Costa Mesa, CA 92626

714-751-4420
TricoRealty.com

Unit Features

 Power: 100A | 120/208

 Clearance Height: 17'

 Ground Level Doors: One 10'x12'

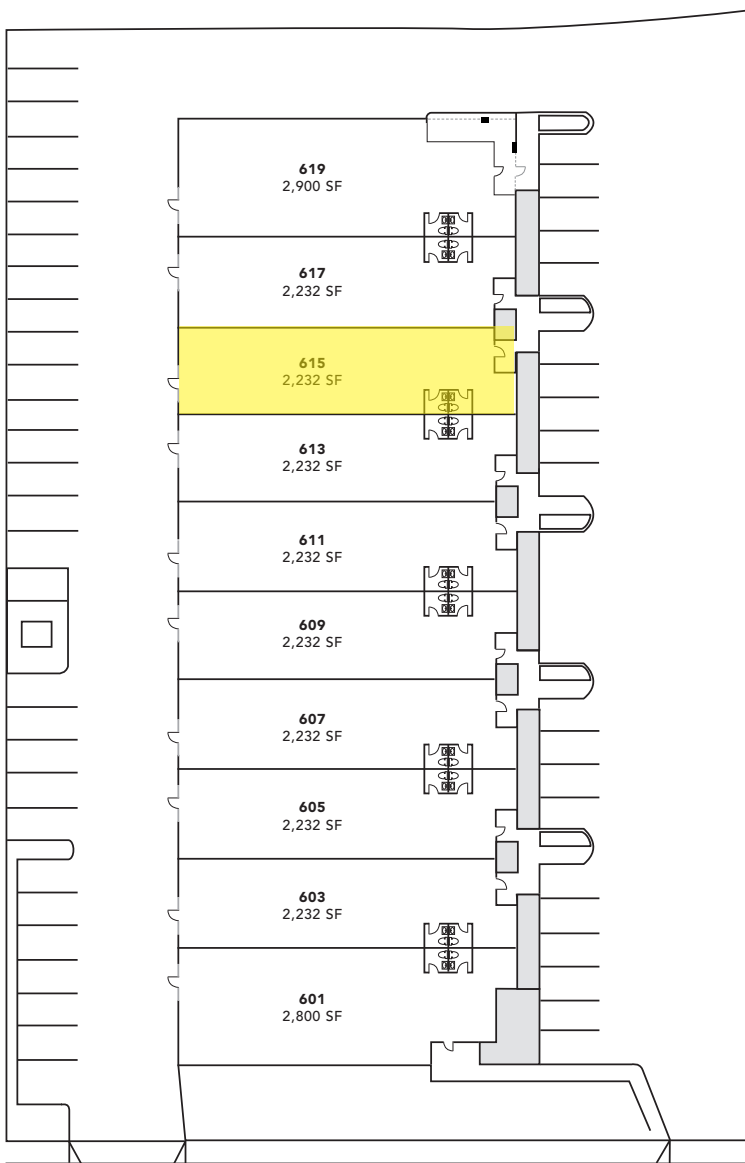

Poplar Street

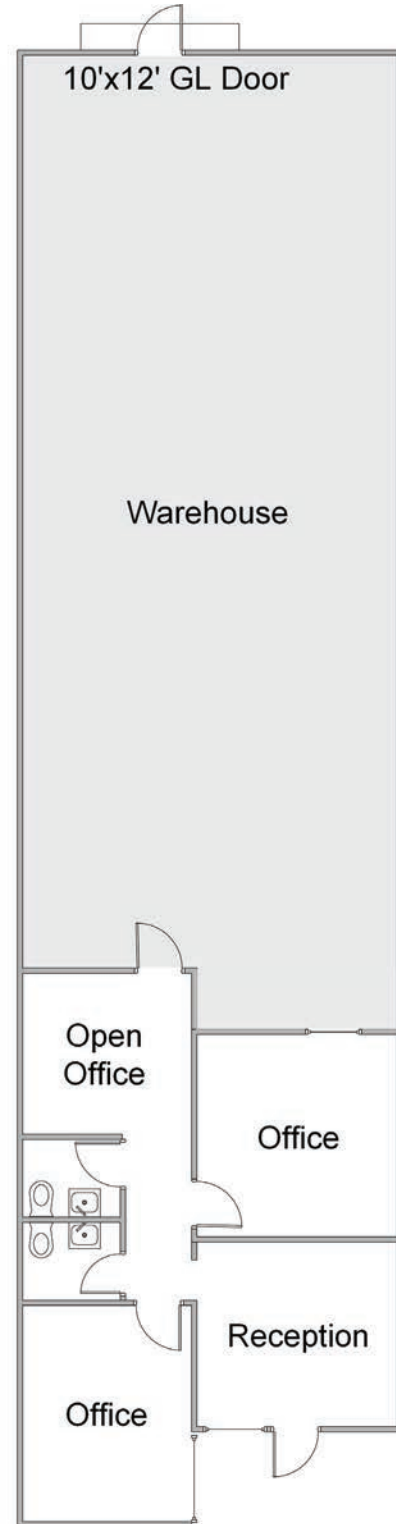

*Floorplans Not to Scale