



FOR LEASE

1603-1605 Monrovia Ave.
Costa Mesa, CA

5,400 SF Industrial Unit

SITE HIGHLIGHTS:

- Business Park Environment
- Premier Westside Costa Mesa Location
- On the Corner of Monrovia Ave / 16th St.
- Close Proximity to the 55 Freeway
- Retail and Restaurant Amenities Nearby
- Professional Property Management
- Zoning: MG - General Industrial

UNIT FEATURES:

- Window Lined Storefronts
- Side-by-Side Units
- Three Large Private Offices
- Four Restrooms
- ± 3,700 SF of Warehouse
- 16' Warehouse Ceiling Height
- Two 10' x 12' Warehouse Roll Up Doors

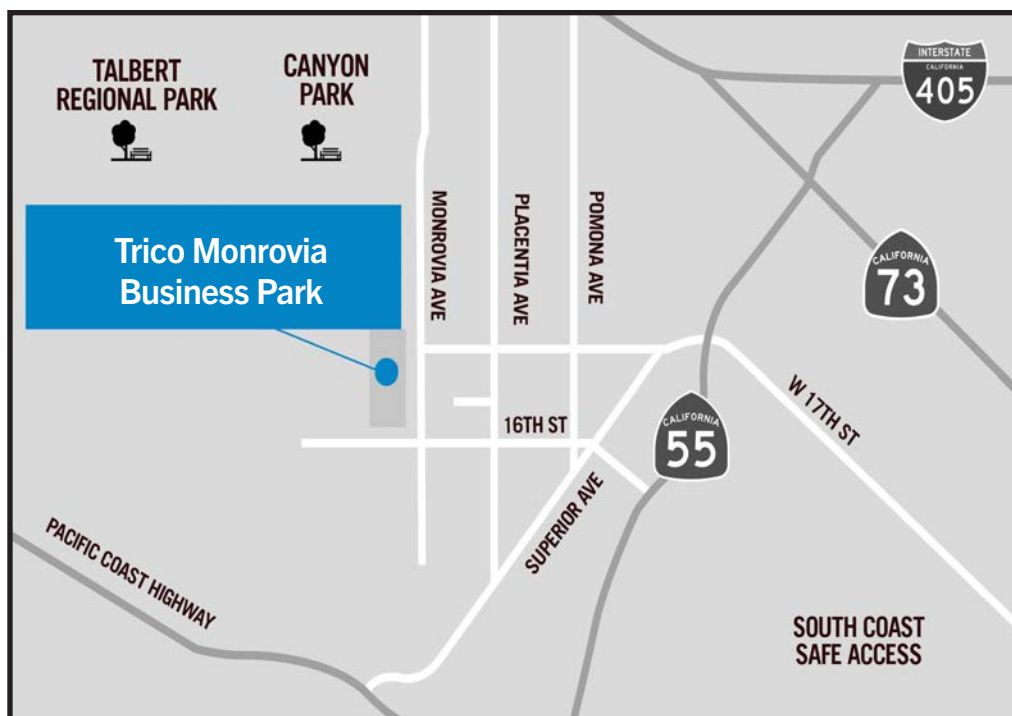

FOR FURTHER DETAILS:

PARKER ROBERTS

parker@tricoREALTY.com
License #01994597

This information has been furnished from sources which we deem reliable; however, we do not guarantee its accuracy and assume no liability. Do not rely on any of the information contained herein without verifying it yourself directly with the listing broker or owner.

Trico Realty, Inc.
License #00342120

3100-A Pullman Street
Costa Mesa, CA 92626

714-751-4420
TricoRealty.com



FOR LEASE

1603-1605 Monrovia Ave.
Costa Mesa, CA

5,400 SF Industrial Unit

Unit Features

 Power: 1603: 150A | 120/208 & 1605: 100A | 120/208

 Clearance Height: 16'

 Ground Level Doors: Two 10'x12'

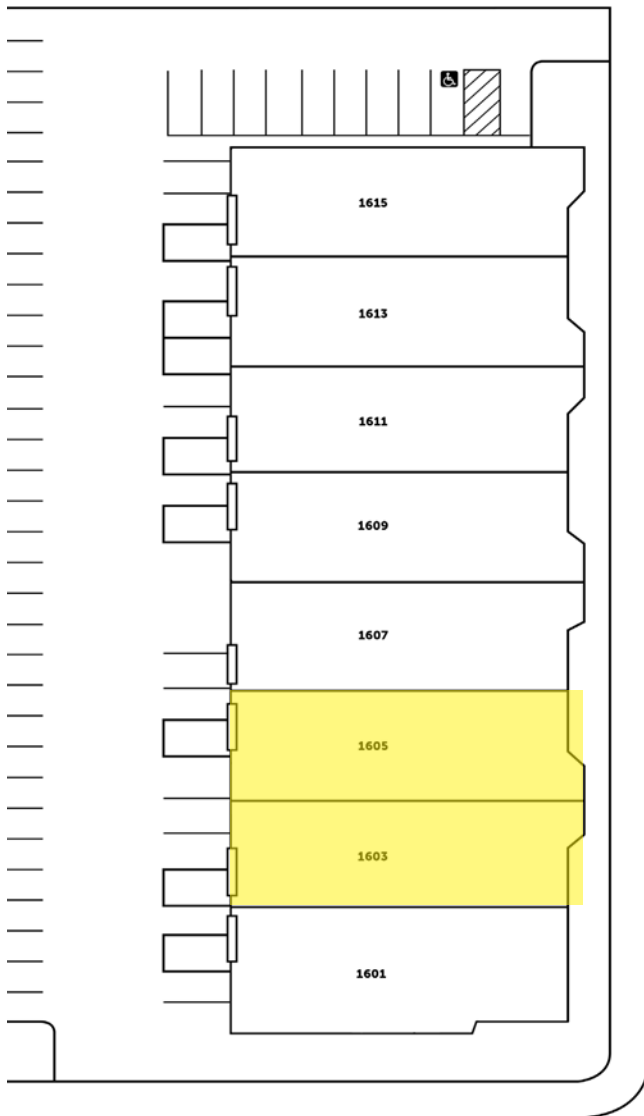

W 16TH ST

MONROVIA AVE

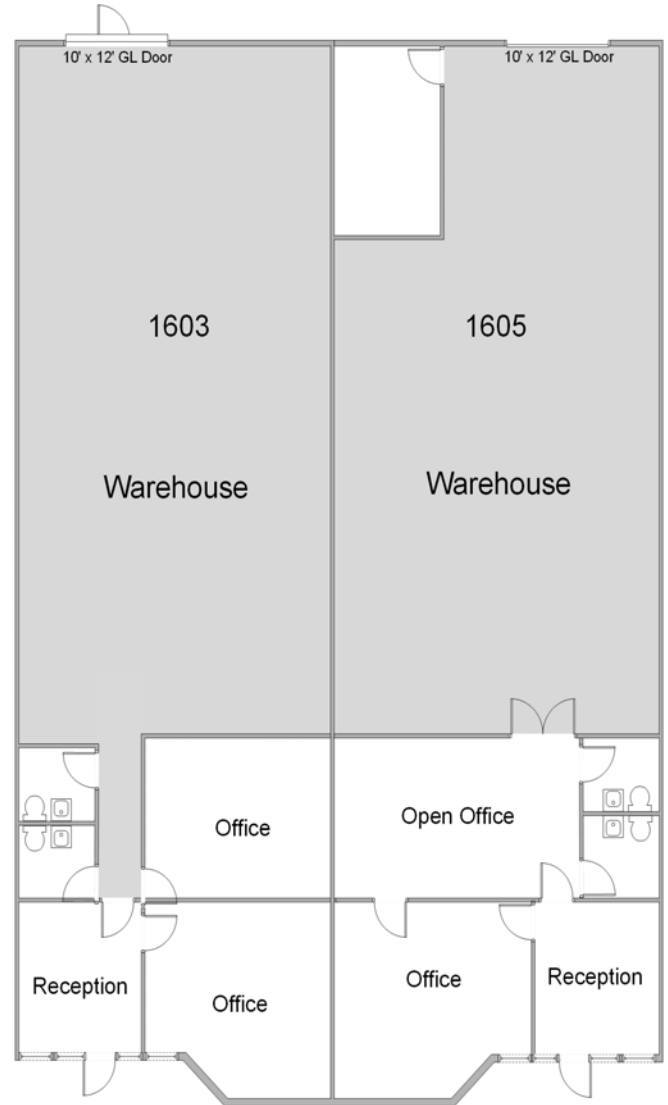

*Floorplans Not to Scale

PARKER ROBERTS
parker@tricoREALTY.com
License #01994597

714-751-4420
TricoREALTY.com
License #00342120