



**FOR LEASE**

**2,400 Square Foot Units**

**FEATURES:**

- Lobby + 3 Offices
- 100% HVAC for Offices
- Office and Warehouse Restroom
- 12' x 12' Overhead Doors
- 16' Clearance
- LVT Flooring
- LED Exterior Lighting
- 3 Phase Power, up to 200 AMPs
- Drive Around Building



**155 E. Liberty Avenue, Anaheim, CA 92801**



This information has been furnished from sources which we deem reliable; however, we do not guarantee its accuracy and assume no liability. Do not rely on any of the information contained herein without verifying it yourself directly with the listing broker or owner.

**FOR FURTHER DETAILS:**

**JOHN PAK**

john@tricoREALTY.com  
BRE #0483069

**Trico Realty, Inc.**

3100-A Pullman Street  
Costa Mesa, CA 92626  
(714) 751-4420 • License #00342120

For additional information  
Visit our Website at [www.TricoRealty.com](http://www.TricoRealty.com)



155 E. Liberty Avenue,  
Anaheim, CA 92801

**FOR LEASE**

2,400 Square Foot Units

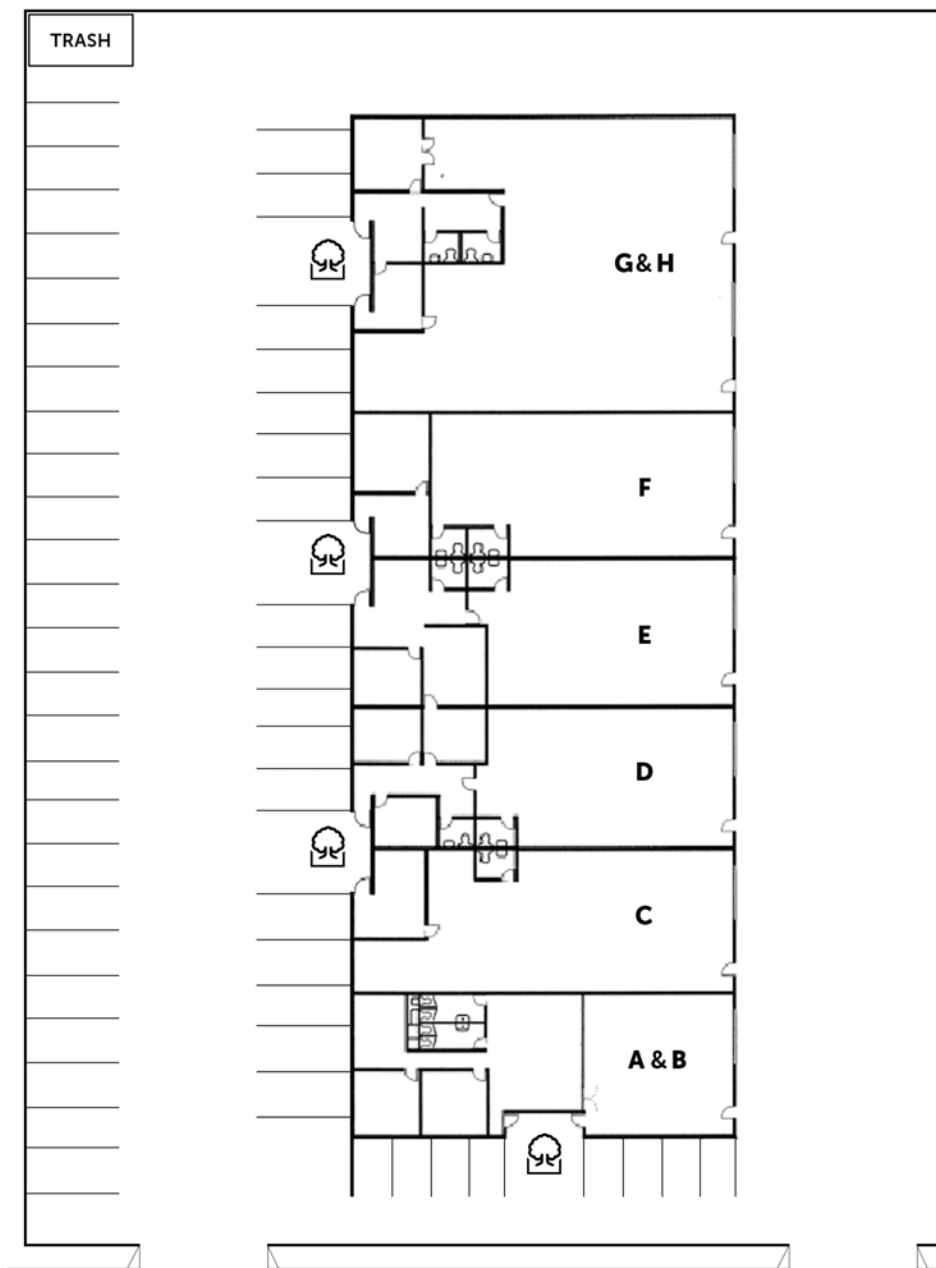

**E. LIBERTY AVENUE**

**Trico Realty, Inc.**

3100-A Pullman Street  
Costa Mesa, CA 92626

(714) 751-4420 • License #00342120

For additional information

Visit our Website at [www.TricoRealty.com](http://www.TricoRealty.com)



155 E. Liberty Avenue,  
Anaheim, CA 92801

**FOR LEASE**

2,400 Square Foot Units



**Trico Realty, Inc.**

3100-A Pullman Street  
Costa Mesa, CA 92626

(714) 751-4420 • License #00342120

For additional information  
Visit our Website at [www.TricoRealty.com](http://www.TricoRealty.com)

