



FOR LEASE

2,900-8,700 Square Foot Units

FEATURES:

OFFICE FEATURES:

- Street Front Exposure
- Approximately 400 Square Feet Office Space Per Unit
- Fluorescent Lighting

WAREHOUSE FEATURES:

- Minimum 100 Amps of Power
- Fluorescent Lighting
- 16 Ft. Clearance
- 12' X 10' Overhead Doors
- One or Two Restrooms Per Unit

OTHER FEATURES:

- Truck Door Lighting
- Close to Ocean



921-957 Newhall Street, Costa Mesa, CA 92627



This information has been furnished from sources which we deem reliable; however, we do not guarantee its accuracy and assume no liability. Do not rely on any of the information contained herein without verifying it yourself directly with the listing broker or owner.

FOR FURTHER DETAILS:

DAVID KLING

david@tricoirealty.com
License #01965659

Trico Realty, Inc.

3100-A Pullman Street
Costa Mesa, CA 92626
(714) 751-4420 • License #00342120

For additional information
Visit our Website at www.TricoRealty.com



921-957 Newhall Street,
Costa Mesa, CA 92627

FOR LEASE

2,900-8,700 Square Foot Units

Site Plan

921-957 Newhall Street, Costa Mesa

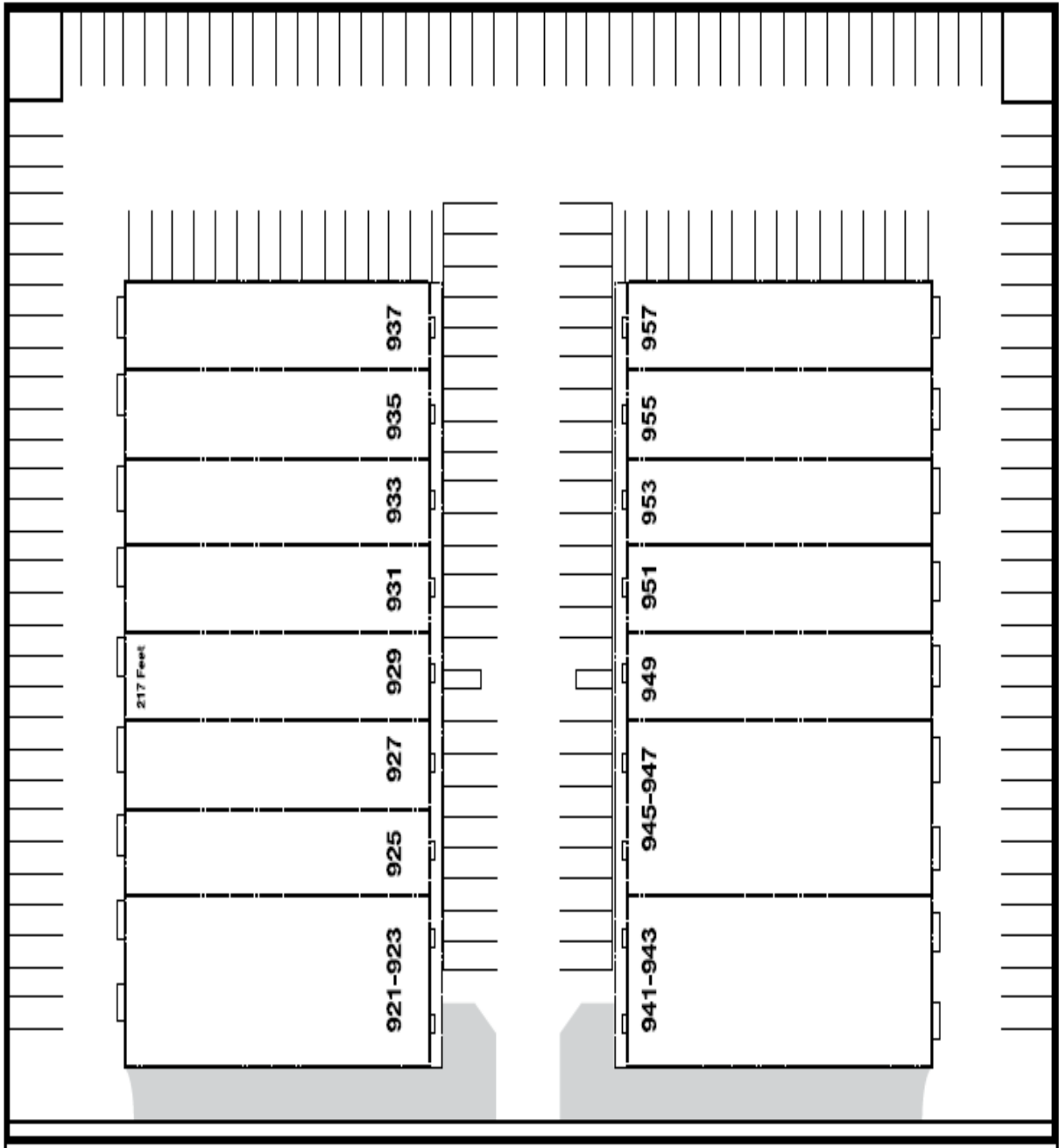

Trico Realty, Inc.

3100-A Pullman Street
Costa Mesa, CA 92626

(714) 751-4420 • License #00342120

For additional information
Visit our Website at www.TricoRealty.com



921-957 Newhall Street,
Costa Mesa, CA 92627

FOR LEASE

2,900-8,700 Square Foot Units

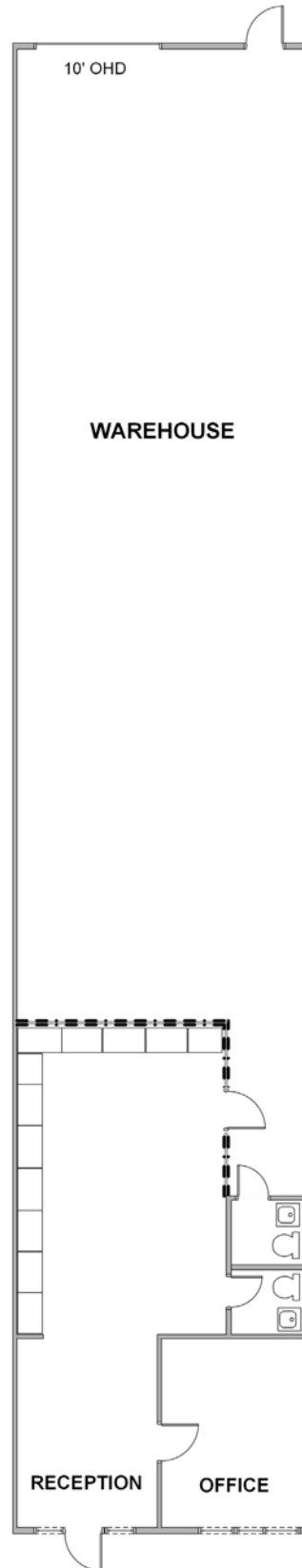

Trico Realty, Inc.

3100-A Pullman Street
Costa Mesa, CA 92626

(714) 751-4420 • License #00342120

For additional information
Visit our Website at www.TricoRealty.com

